



ChaneyBrooks

FOR LEASE

780 S. BERETANIA STREET

Honolulu, HI 96813

A VARIETY OF OPPORTUNITIES

Ground floor space with large open areas, high ceilings, plumbing/restrooms within the space, and outdoor space available in the back of the property. Situated along a major thoroughfare with close proximity to the urban density of downtown Honolulu, 780 S. Beretania presents a variety of opportunities. Parking can be made available two blocks away.



FOR LEASE

FOR LEASE

780 S. BERETANIA STREET

Honolulu, HI 96813

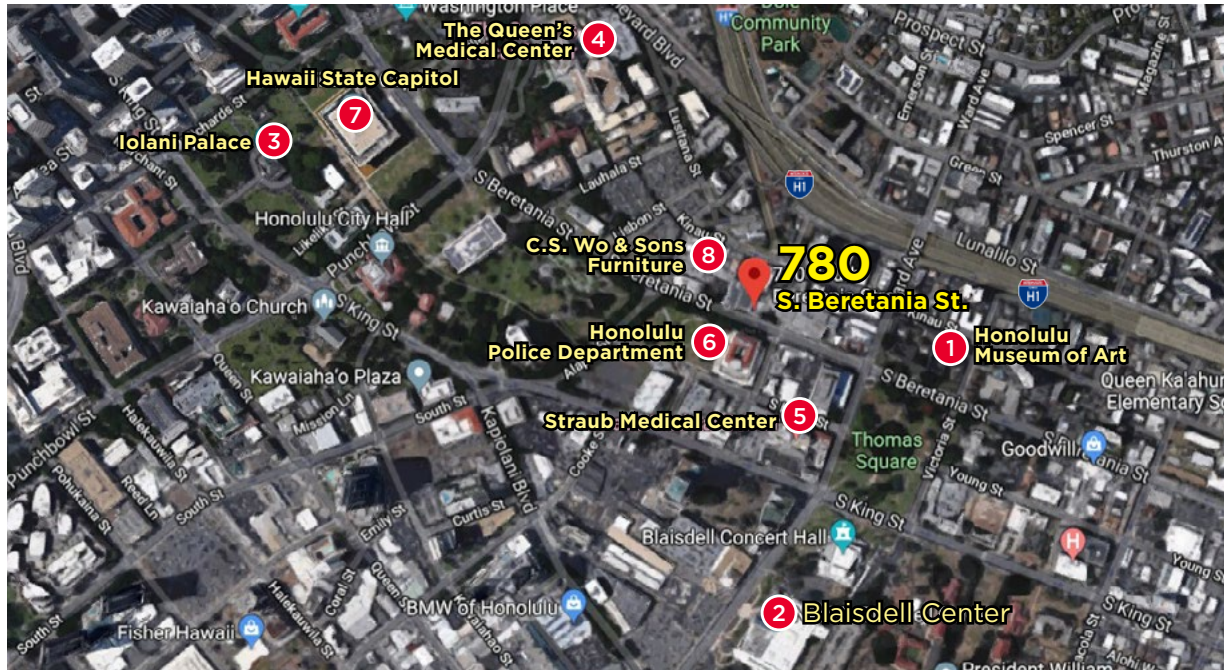

NEAR-BY AMENITIES & EMPLOYERS

- 1 Honolulu Museum of Art
- 2 Blaisdell Center
- 3 Iolani Palace
- 4 The Queen’s Medical Center
- 5 Straub Medical Center
- 6 Honolulu Police Department
- 7 Hawaii State Capitol
- 8 C. S. Wo & Sons Furniture

PROPERTY DETAILS

Size	6,200 SF (Building) 8,400 SF (Lot)
Modified Gross Rent	\$2.30/SF/Mo
Term	3 - 5 Years
Electricity	Separately Metered
Zoning	BMX-3

IDEAL USES

- Co-working space
- Mattress store
- Creative office space
- Music store
- Convenience store
- Non-profit
- Storage

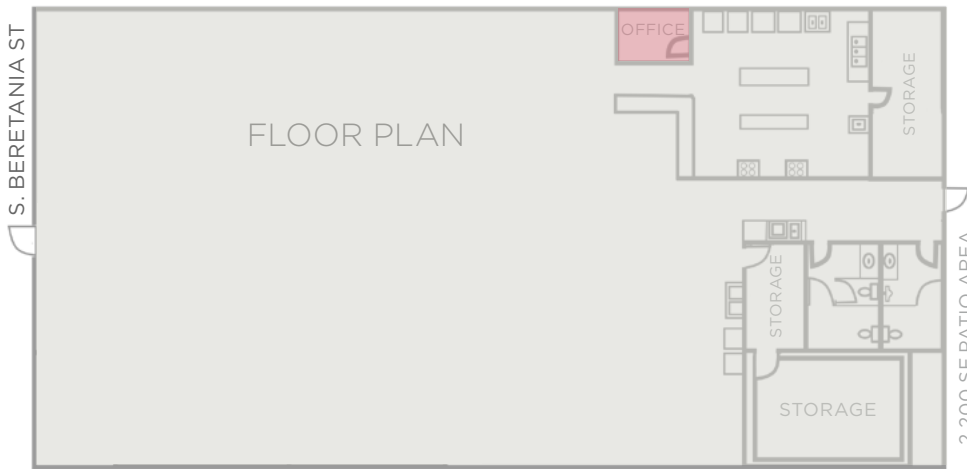

EXCLUSIVE LISTING AGENTS

DANKA FABIANKOVICOVA (S)

Vice President
+1 808 544 1820
dfabiankovicova@chaneybrooks.com
RS-67466

PAUL D. YEE (S)

Real Estate Advisor
+1 808 386 9849
pyee@chaneybrooks.com
RS-75218

©2024 Cushman & Wakefield ChaneyBrooks. All rights reserved. The information contained in this communication is strictly confidential. This information has been obtained from sources believed to be reliable but has not been verified. NO WARRANTY OR REPRESENTATION, EXPRESS OR IMPLIED, IS MADE AS TO THE CONDITION OF THE PROPERTY (OR PROPERTIES) REFERENCED HEREIN OR AS TO THE ACCURACY OR COMPLETENESS OF THE INFORMATION CONTAINED HEREIN, AND SAME IS SUBMITTED SUBJECT TO ERRORS, OMISSIONS, CHANGE OF PRICE, RENTAL OR OTHER CONDITIONS, WITHDRAWAL WITHOUT NOTICE, AND TO ANY SPECIAL LISTING CONDITIONS IMPOSED BY THE PROPERTY OWNER(S). ANY PROJECTIONS, OPINIONS OR ESTIMATES ARE SUBJECT TO UNCERTAINTY AND DO NOT SIGNIFY CURRENT OR FUTURE PROPERTY PERFORMANCE.



EXCLUSIVE LISTING AGENTS

DANKA FABIANKOVICOVA (S)
Vice President
+1 808 544 1820
dfabiankovicova@chaneybrooks.com
RS-67466

PAUL D. YEE (S)
Real Estate Advisor
+1 808 386 9849
pyee@chaneybrooks.com
RS-75218

©2024 Cushman & Wakefield ChaneyBrooks. All rights reserved. The information contained in this communication is strictly confidential. This information has been obtained from sources believed to be reliable but has not been verified. NO WARRANTY OR REPRESENTATION, EXPRESS OR IMPLIED, IS MADE AS TO THE CONDITION OF THE PROPERTY (OR PROPERTIES) REFERENCED HEREIN OR AS TO THE ACCURACY OR COMPLETENESS OF THE INFORMATION CONTAINED HEREIN, AND SAME IS SUBMITTED SUBJECT TO ERRORS, OMISSIONS, CHANGE OF PRICE, RENTAL OR OTHER CONDITIONS, WITHDRAWAL WITHOUT NOTICE, AND TO ANY SPECIAL LISTING CONDITIONS IMPOSED BY THE PROPERTY OWNER(S). ANY PROJECTIONS, OPINIONS OR ESTIMATES ARE SUBJECT TO UNCERTAINTY AND DO NOT SIGNIFY CURRENT OR FUTURE PROPERTY PERFORMANCE.