



ChaneyBrooks



FOR LEASE

94-027 WAIPAHU DEPOT ST

WAIPAHU, HI 96797



Located in the heart of Waipahu, this 19,400 SF lot is available to lease as early as mid-December. Lot fronting Waipahu Depot Street provides easy access to Farrington Hwy. Within minutes of the H1 East or West bound. Landlord willing to split the cost to bring water and electricity to the property if needed. Fenced and secured lot with a portion that is paved. Waipahu Depot Street provides great access for users who need to bring in large trucks or equipment. Don't miss out on this opportunity for open space in Waipahu!

PROPERTY DETAILS

LOCATION	Waipahu, HI
TMK	(1) 9-4-20-32
BASE RENT	\$0.30/SF/Month
RPT	\$0.08/SF/Month
ZONING	I-2
SIZE	19,400 SF
TERM	3-5 Years
AVAILABLE	Dec 15, 2023



CONTACT US FOR MORE INFORMATION

ANTHONY PROVENZANO (B), CCIM, SIOR

+1 808 387 3444

aprovenzano@chaneybrooks.com

KELLY A. VEA (S)

+1 808 489 2703

kvea@chaneybrooks.com

ROBERT HUANG (S)

+1 808 358 6217

rhuang@chaneybrooks.com

1440 Kapiolani Boulevard, Suite 1010
Honolulu, Hawaii 96814

www.chaneybrooks.com

©2023 Cushman & Wakefield ChaneyBrooks. All rights reserved. The information contained in this communication is strictly confidential. This information has been obtained from sources believed to be reliable but has not been verified. NO WARRANTY OR REPRESENTATION, EXPRESS OR IMPLIED, IS MADE AS TO THE CONDITION OF THE PROPERTY (OR PROPERTIES) REFERENCED HEREIN OR AS TO THE ACCURACY OR COMPLETENESS OF THE INFORMATION CONTAINED HEREIN, AND SAME IS SUBMITTED SUBJECT TO ERRORS, OMISSIONS, CHANGE OF PRICE, RENTAL OR OTHER CONDITIONS, WITHDRAWAL WITHOUT NOTICE, AND TO ANY SPECIAL LISTING CONDITIONS IMPOSED BY THE PROPERTY OWNER(S). ANY PROJECTIONS, OPINIONS OR ESTIMATES ARE SUBJECT TO UNCERTAINTY AND DO NOT SIGNIFY CURRENT OR FUTURE PROPERTY PERFORMANCE.



ChaneyBrooks



FOR LEASE

94-027 WAIPAHU DEPOT ST

WAIPAHU, HI 96797



EASY ACCESS, SECURED PAVED LOT

- Available Dec 15, 2023

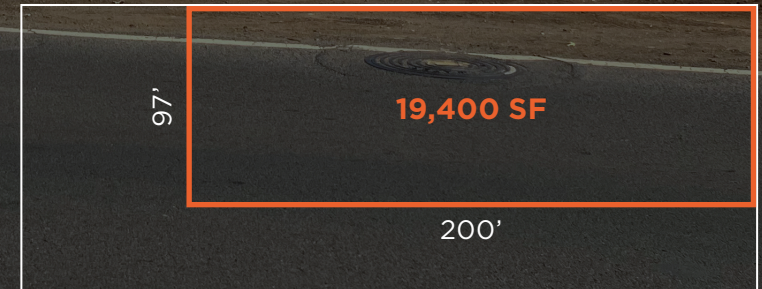

Waipahu Depot St

CONTACT US FOR MORE INFORMATION

ANTHONY PROVENZANO (B), CCIM, SIOR

+1 808 387 3444

aprovenzano@chaneybrooks.com

KELLY A. VEA (S)

+1 808 489 2703

kvea@chaneybrooks.com

ROBERT HUANG (S)

+1 808 358 6217

rhuang@chaneybrooks.com

1440 Kapiolani Boulevard, Suite 1010
Honolulu, Hawaii 96814

www.chaneybrooks.com

©2023 Cushman & Wakefield ChaneyBrooks. All rights reserved. The information contained in this communication is strictly confidential. This information has been obtained from sources believed to be reliable but has not been verified. NO WARRANTY OR REPRESENTATION, EXPRESS OR IMPLIED, IS MADE AS TO THE CONDITION OF THE PROPERTY (OR PROPERTIES) REFERENCED HEREIN OR AS TO THE ACCURACY OR COMPLETENESS OF THE INFORMATION CONTAINED HEREIN, AND SAME IS SUBMITTED SUBJECT TO ERRORS, OMISSIONS, CHANGE OF PRICE, RENTAL OR OTHER CONDITIONS, WITHDRAWAL WITHOUT NOTICE, AND TO ANY SPECIAL LISTING CONDITIONS IMPOSED BY THE PROPERTY OWNER(S). ANY PROJECTIONS, OPINIONS OR ESTIMATES ARE SUBJECT TO UNCERTAINTY AND DO NOT SIGNIFY CURRENT OR FUTURE PROPERTY PERFORMANCE.