

FEE SIMPLE RETAIL COMMERCIAL CONDOS
FOR SALE



ChaneyBrooks

909 KAPIOLANI BLVD.,
APT C-A, C-B, C-C
Honolulu, HI 96814



GROUND FLOOR COMMERCIAL CONDOS

PROPERTY DETAILS

Asking Price	: \$3,500,000
2019 Annualized NOI	: \$104,185
CAM	: \$0.70/SF/MO
RPT	: \$0.81/SF/MO
TMK	: (1) 2-3-003:073, CPR Nos. 228,229 & 230
Size	: 660 SF; 1,342 SF; & 1,147 SF
Tenure	: Fee Simple
Zoning	: KAK (HCDA)
Parking	: 18 Deeded Stalls

PROPERTY HIGHLIGHTS

- Highly Visible Ground Floor Commercial Condos
- Includes 18 Deeded Parking Stalls
- 100% Leased Through 2024
- Unit C-B has Exclusive Use of Large Outdoor Seating Area
- Prime Corner Location on Major Thoroughfares of Kapiolani Boulevard and Ward Avenue
- Across from the Blaisdell Arena
- Four Blocks from the Future Kakaako Rail Station

CONTACT US FOR MORE INFORMATION

SALVADOR A. FASI* (B)

+1 808 544 9561
sfasi@chaneybrooks.com

1440 Kapiolani Blvd., Suite 1010, Honolulu, Hawaii 96814
www.chaneybrooks.com

*Principal Broker of Fasi Realty Advisors, LLC, working exclusively with Cushman & Wakefield ChaneyBrooks

Independently Owned and Operated / A Member of the Cushman & Wakefield Alliance

©2019 Cushman & Wakefield ChaneyBrooks. All rights reserved. The information contained in this communication is strictly confidential. This information has been obtained from sources believed to be reliable but has not been verified. NO WARRANTY OR REPRESENTATION, EXPRESS OR IMPLIED, IS MADE AS TO THE CONDITION OF THE PROPERTY (OR PROPERTIES) REFERENCED HEREIN OR AS TO THE ACCURACY OR COMPLETENESS OF THE INFORMATION CONTAINED HEREIN, AND SAME IS SUBMITTED SUBJECT TO ERRORS, OMISSIONS, CHANGE OF PRICE, RENTAL OR OTHER CONDITIONS, WITHDRAWAL WITHOUT NOTICE, AND TO ANY SPECIAL LISTING CONDITIONS IMPOSED BY THE PROPERTY OWNER(S). ANY PROJECTIONS, OPINIONS OR ESTIMATES ARE SUBJECT TO UNCERTAINTY AND DO NOT SIGNIFY CURRENT OR FUTURE PROPERTY PERFORMANCE.



ChaneyBrooks

FEE SIMPLE RETAIL COMMERCIAL CONDOS FOR SALE

909 KAPIOLANI BLVD.,
APT C-A, C-B, C-C

Honolulu, HI 96814

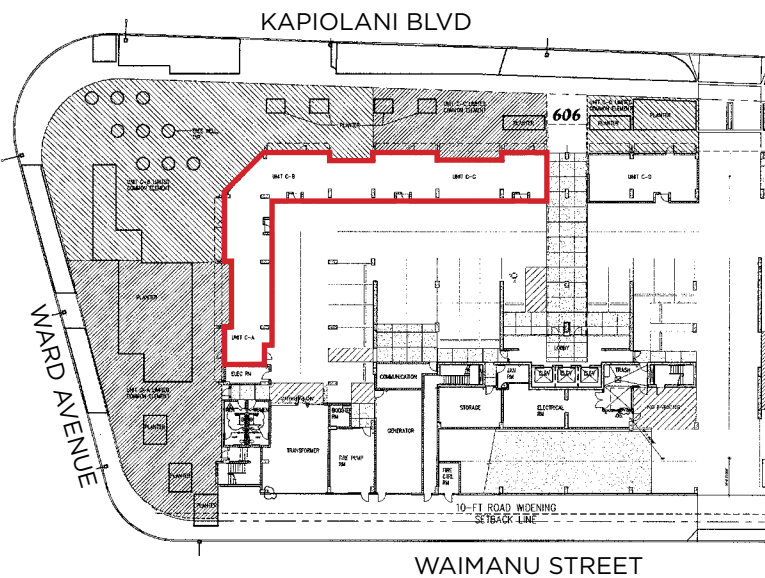

DEMOGRAPHICS

	1 Mile	3 Mile	5 Mile
2019 Total Population	49,625	224,739	330,150
2019 Total Households	24,658	95,685	127,692
Median Household Inc.	\$63,175	\$62,470	\$67,694
Median Home Value	\$578,184	\$619,792	\$697,117

CONTACT US FOR MORE INFORMATION

SALVADOR A. FASI* (B)

+1 808 544 9561

sfasi@chaneybrooks.com

1440 Kapiolani Blvd., Suite 1010, Honolulu, Hawaii 96814

www.chaneybrooks.com

*Principal Broker of Fasi Realty Advisors, LLC, working exclusively with Cushman & Wakefield ChaneyBrooks

Independently Owned and Operated / A Member of the Cushman & Wakefield Alliance

©2019 Cushman & Wakefield ChaneyBrooks. All rights reserved. The information contained in this communication is strictly confidential. This information has been obtained from sources believed to be reliable but has not been verified. NO WARRANTY OR REPRESENTATION, EXPRESS OR IMPLIED, IS MADE AS TO THE CONDITION OF THE PROPERTY (OR PROPERTIES) REFERENCED HEREIN OR AS TO THE ACCURACY OR COMPLETENESS OF THE INFORMATION CONTAINED HEREIN, AND SAME IS SUBMITTED SUBJECT TO ERRORS, OMISSIONS, CHANGE OF PRICE, RENTAL OR OTHER CONDITIONS, WITHDRAWAL WITHOUT NOTICE, AND TO ANY SPECIAL LISTING CONDITIONS IMPOSED BY THE PROPERTY OWNER(S). ANY PROJECTIONS, OPINIONS OR ESTIMATES ARE SUBJECT TO UNCERTAINTY AND DO NOT SIGNIFY CURRENT OR FUTURE PROPERTY PERFORMANCE.