



CUSHMAN &
WAKEFIELD

ChaneyBrooks

FOR LEASE

POLYNESIAN PLAZA

2131 Kalakaua Avenue | Waikiki, HI



PROPERTY DESCRIPTION

Polynesian Plaza is located on the makai side of Kalakaua Avenue, the primary commercial and hotel corridor within Waikiki. Waikiki is a vibrant, distinct, high-activity shopping, resort and residential district that features high-end retailers, nightclubs, restaurants, and entertainment opportunities. Polynesian Plaza is a prime location and great opportunity for your business.



PROPERTY DETAILS

Base Rent:	
Suite 5 & 6	\$18.00/SF/MO
CAM:	\$2.30/SF/MO
Term:	3-5 Years
Spaces Available:	
Suite 5&6	3,622 SF*



*Approximate sizes

PROPERTY HIGHLIGHTS

- + Prime location in popular top-tier tourist destination
- + Excellent visibility on world famous Kalakaua Avenue
- + Prominent space with high pedestrian & vehicle traffic
- + Within walking distance of world-class dining, recreational activities, shopping and nightlife
- + Nearby tenants include Hard Rock Café, Tommy Bahama Restaurant, Bar & Store, and Luxury Row with tenants such as Chanel, Gucci, Moncler, Miu Miu, Bottega Veneta and Golden Goose



SITE PLAN

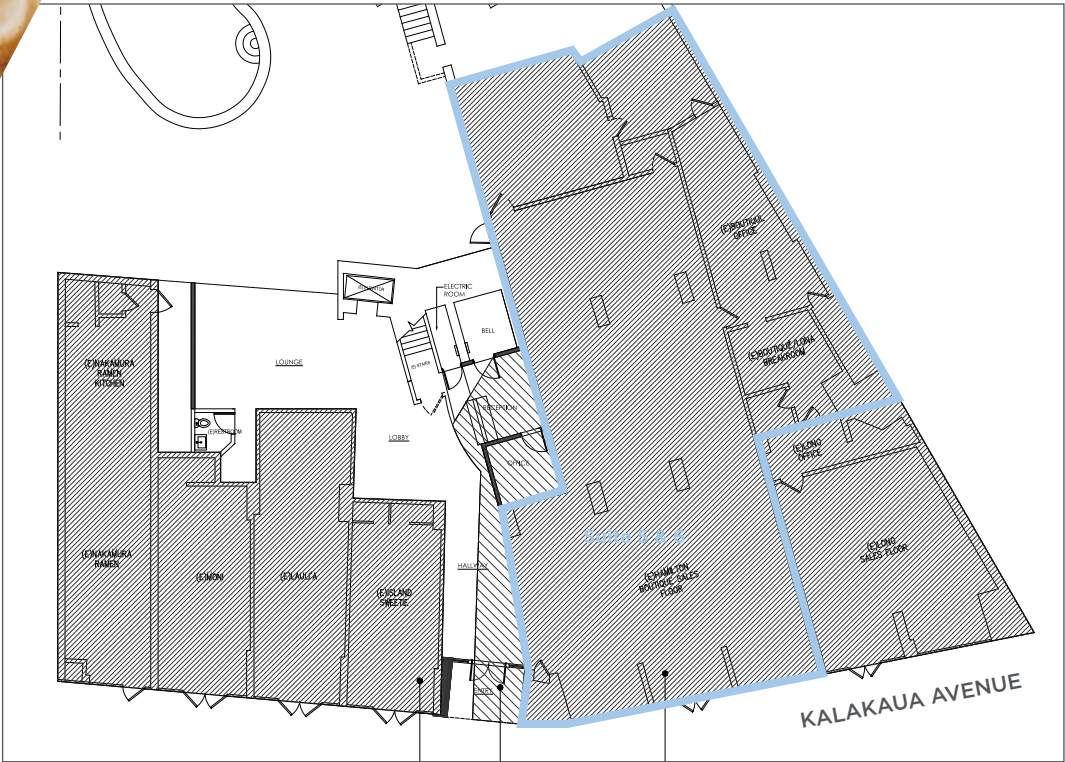

POLYNESIAN PLAZA

CONTACT

ANDREW D. STARN (B)
Senior Vice President
+1 808 387 8424
astarn@chaneybrooks.com

TEA GIACOMELLI (S)
Real Estate Advisor
+1 808 754 7632
tgiacomelli@chaneybrooks.com

1440 Kapiolani Blvd. Suite 1010
Honolulu, HI 96814
Main +1 808 544 1600
Fax +1 808 544 9574

©2022 CUSHMAN & WAKEFIELD CHANEYBROOKS. NO WARRANTY OR REPRESENTATION, EXPRESS OR IMPLIED, IS MADE TO THE ACCURACY OR COMPLETENESS OF THE INFORMATION CONTAINED HEREIN, AND SAME IS SUBMITTED SUBJECT TO ERRORS, OMISSIONS, CHANGE OF PRICE, RENTAL OR OTHER CONDITIONS, WITHDRAWAL WITHOUT NOTICE, AND TO ANY SPECIAL LISTING CONDITIONS IMPOSED BY THE PROPERTY OWNER(S). AS APPLICABLE, WE MAKE NO REPRESENTATION AS TO THE CONDITION OF THE PROPERTY (OR PROPERTIES) IN QUESTION.

